

SIEMENS
Ingenuity for Life

Space Pressurization: Concept and Practice

ASHRAE Boston Chapter Meeting
February 2026

© Siemens Smart Infrastructure 2026

1



DISTINGUISHED LECTURER PROGRAM

This ASHRAE Distinguished Lecturer is brought to you by the ASHRAE Society Chapter Technology Transfer Committee

Lecturer presentations and/or opinions do not necessarily reflect the policies or position of ASHRAE or the chapter.

Please!
Silence Phones
Distinguished Lecturer Evaluation Forms are very important. Please complete at the end of the presentation and return to the CTTC or Program Chair.

More information on the DL program available at:
www.ashrae.org/distinguishedlecturers

© Copyright 2026
Page 2

2

LEADERSHIP WANTED!

www.ashrae.org/volunteer

**BECOME A FUTURE LEADER IN ASHRAE –
WRITE THE NEXT CHAPTER IN YOUR CAREER**

ASHRAE Members who are active at their chapter and society become leaders and bring information and technology back to their job.

YOU ARE NEEDED FOR:

- ❖ Society Technical Committees
- ❖ Society Standard Committees
- ❖ Young Engineers in ASHRAE
- ❖ Chapter Membership Promotion
- ❖ Chapter Research Promotion
- ❖ Chapter Student Activities
- ❖ Chapter Technology Transfer



Find your Place in ASHRAE and volunteer

© Copyright 2026
Page 3

3

Course Description

Space Pressurization: Concept and Practice

Program teaches ventilation control design for critical pressurized spaces such as laboratories, clean rooms and health care facilities. Topics run from basic physics of pressurization, through air flow control technology and detailed design procedures. Covers goals and concepts behind pressurization. Emphasis on the importance of the room envelope. Explains the common control methods, and when to choose each one.

© Copyright 2026
Page 4

4

Learning Objectives

Apply space pressurization as a tool
for contamination control

Recognize the effect of the room envelope
on successful pressurization

Select an appropriate pressurization control method
for an application

Design pressurization details for effective
contamination control

© Copyright 2026
Page 5

5

Agenda

- | | |
|---|--|
| 1 | Introduction (concept, purpose, ...) 5 min |
| 2 | Physics: Infiltration and Containment 10 min |
| 3 | Pressurization Methods 10 min |
| 4 | Design Considerations 8 min |
| 5 | Summary and Contamination Control 8 min |

© Copyright 2020
Page 6

6

Room Pressurization:

A ventilation technology that controls migration of air contaminants by inducing drafts between spaces



7

Room pressurization

Exhaust system removes air

Supply system delivers less air

Room pressure is negative

Infiltration makes up the difference

Inward air flow contains pollutants

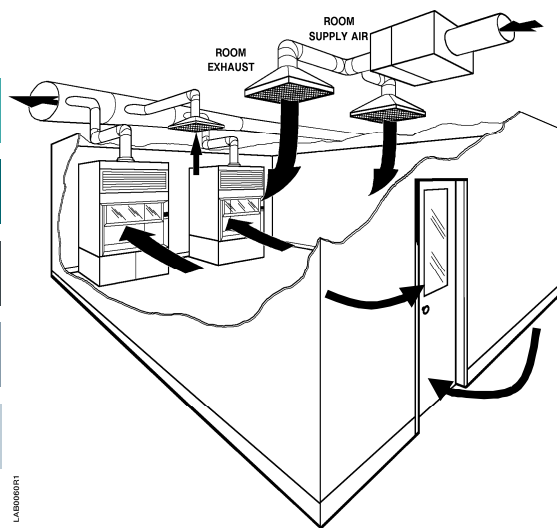

© Copyright 2026
Page 8

8

Introduction: Who uses it? Why?

Biological and Chemical Laboratories

- prevent spread of airborne hazards

Hospital Isolation Rooms

- protect patients and staff from germs

Hospital Pharmacies

- facilitate sterile compounding

Clean Manufacturing

- maintain product quality

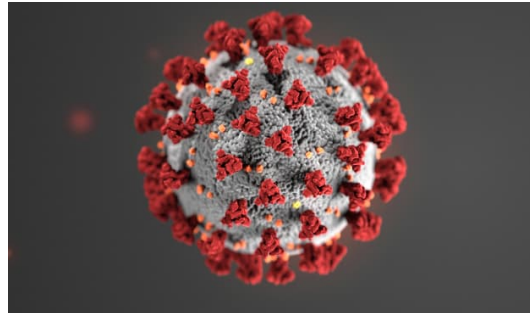

© Copyright 2026
Page 9

9

Introduction: Who else uses it?

Office towers

- control smoke in a fire; maintain exit path

Any Building

- separate rest rooms from other spaces

Restaurants

- keep kitchen smells out of the dining room

Any Building

- keep unconditioned OA out of occupied spaces

These uses are out of today's scope

© Copyright 2026
Page 10

10

How do you define success?

Success

is control of
contaminants,
not flows and
pressure values



© Copyright 2026
Page 12

12

Agenda

- 1 Introduction (concept, purpose, ...)
- 2 Physics: Infiltration and Containment
- 3 Pressurization Methods
- 4 Design Considerations
- 5 Summary and Contamination Control

© Copyright 2020
Page 13

13

Infiltration and containment

Infiltration: mechanical process

Velocity, Area, Pressure

Infiltration Curves

Importance of the Envelope

Select Pressurization Level

© Copyright 2026
Page 14

14

Infiltration process: pressure, velocity, area, flow

Infiltration is a physical process

Pressurization is an
engineered result

ASHRAE Handbook and
Ventilation Manual from
ACGIH model the process

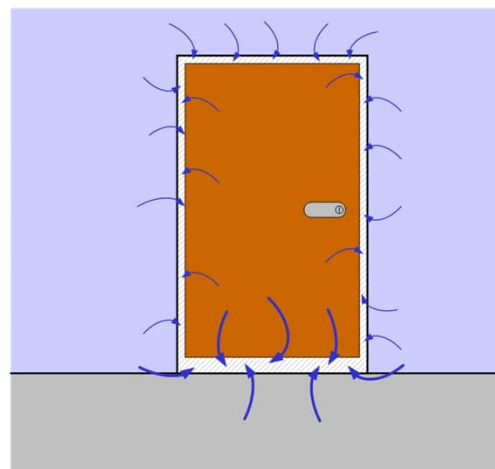

© Copyright 2026
Page 15

15

Pressure vs. velocity

Simple approach is to model the velocity with a discharge coefficient

ACGIH Industrial Ventilation: 7-3

$$v = 0.6(4000)\sqrt{\Delta P}$$

ASHRAE Fundamentals Handbook presents more complex model, but the result is nearly the same

© Copyright 2026
Page 16

16

Infiltration model for pressurization

Air velocity through gaps in envelope controls contaminants

Velocity related to pressure by orifice flow

What velocity do we need?

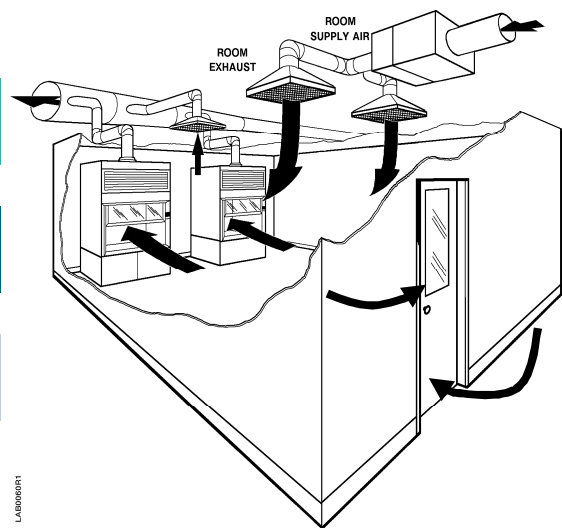

© Copyright 2026
Page 17

17

Reality of room air motion

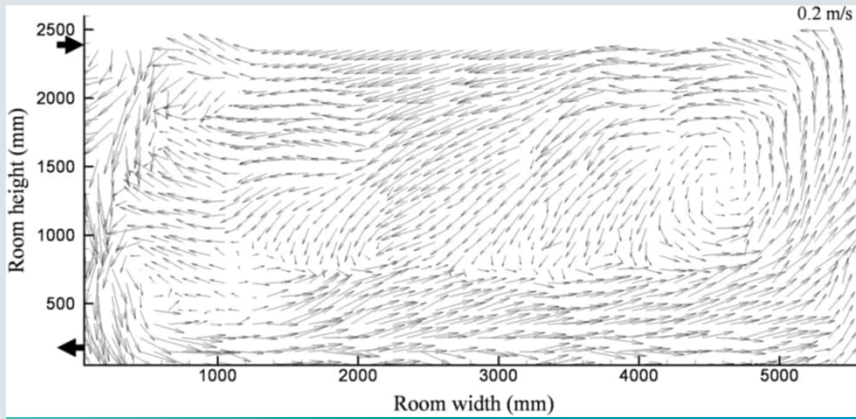

"Particle Image Velocimetry." Photograph of flow field (2D) in cross-section of a room.
Zhao L., ASHRAE Transactions, DA-07-044

© Copyright 2026
Page 18

18

Velocity and leakage area

Flow is velocity times area

ASHRAE Handbook HVAC Applications, puts it together:

$$Q = 2610 A \sqrt{\Delta P}$$

Q = infiltration flow, cfm
A = leakage area, sq. ft.
 ΔP = pressure across envelope, inwc



© Copyright 2026
Page 19

19

Infiltration curve: Pressure difference vs. infiltrating flow

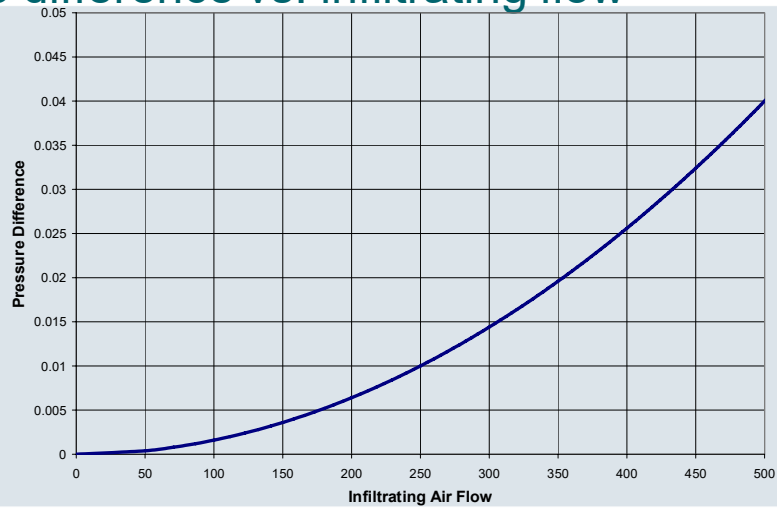

© Copyright 2026
Page 20

20

Infiltration curve: Several values of leakage area

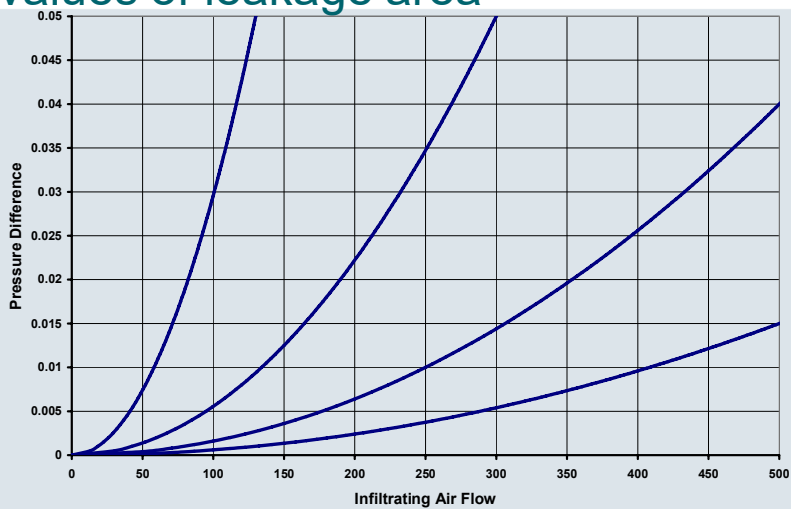

© Copyright 2026
Page 21

21

Importance of the envelope

- Leakage area is main mechanical parameter in the pressurization system
- Like knowing the hx characteristics to apply a heating coil
- Like knowing the pipe diameter in a hydronic system

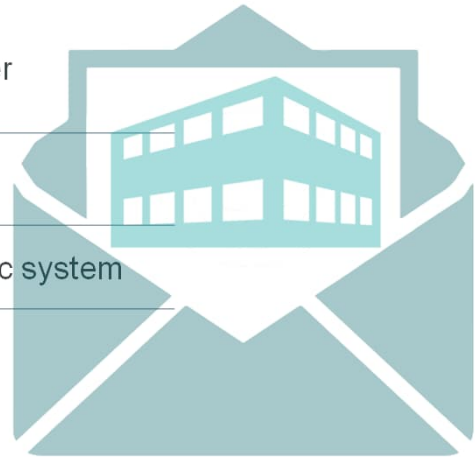

© Copyright 2026
Page 22

22

Select pressurization level

Choose the flow offset
Let it determine the pressure

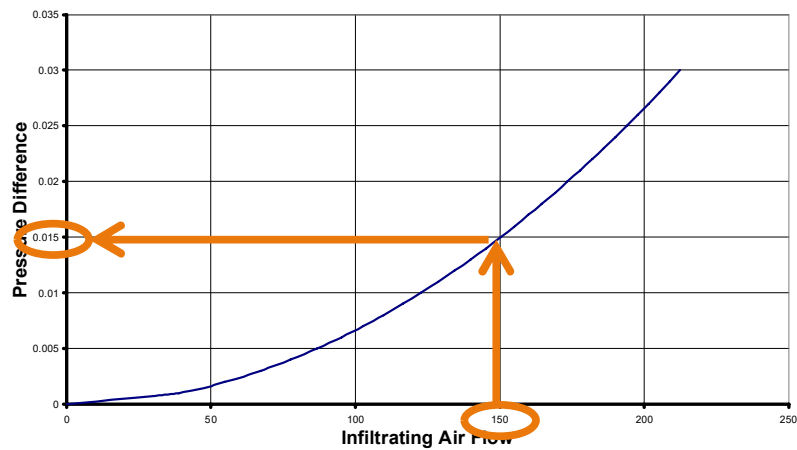

© Copyright 2026
Page 23

23

Select pressurization level

Choose the pressure
Let it determine the flow offset

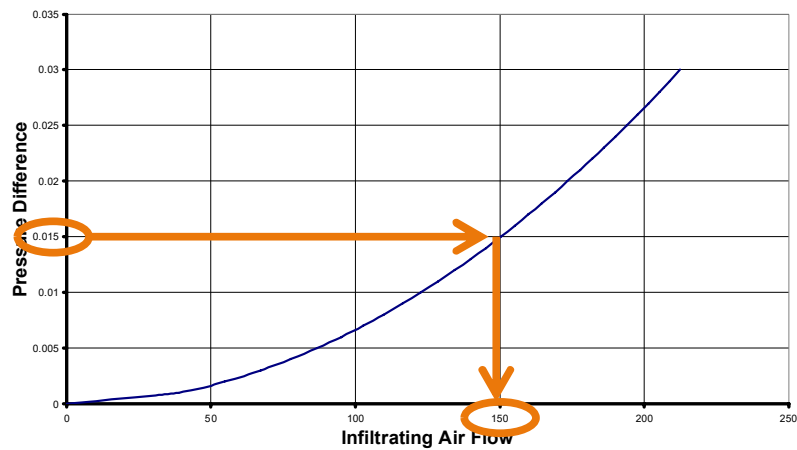

24

Select pressurization level

Different ways to express the level of pressurization

- in terms of the pressure difference
- in terms of the infiltration flow

“Specify either the pressure
or the flow offset, not both.”

Unless you are trying to specify the envelope

© Copyright 2026
Page 25

25

Pressurization and contaminant control

Positive room pressure drives air and contaminants out

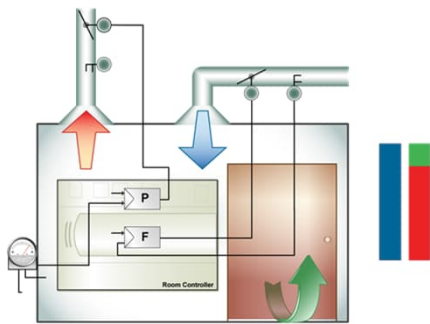

Negative room pressure draws air and contaminants in

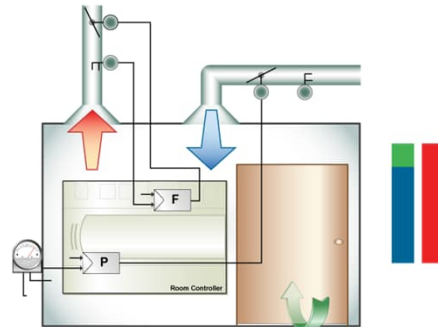

Neutral room pressure exchanges air and contaminants both directions

© Copyright 2026
Page 26

26

Control methods compared

Three widely-published methods

1 Space pressure feedback

2 Differential flow control

3 Cascade control

References:

2023 ASHRAE Handbook, HVAC Applications. Chapter 17 Laboratory Systems
Siemens Building Technologies: Doc #125-2412. Room Pressurization Control

© Copyright 2026
Page 28

28

Space pressure feedback

Measure pressure difference across room boundary

Compare to selected setpoint

Adjust supply flow or exhaust to maintain pressure difference

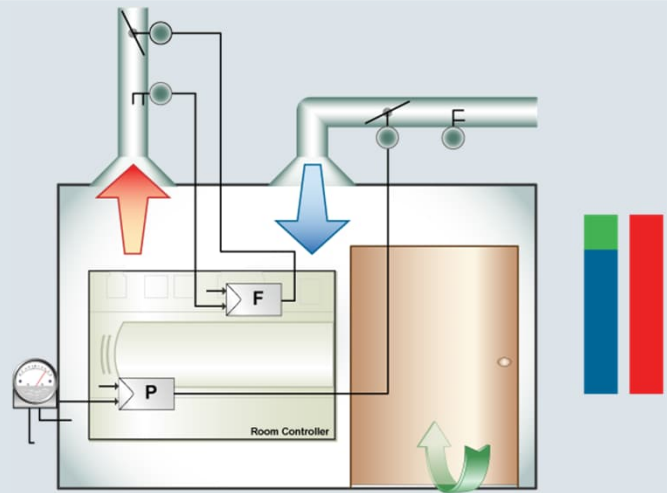

© Copyright 2026
Page 29

29

Differential flow control

Carefully control air supply to room

Carefully control all exhaust from room

Enforce a difference between supply and exhaust

Select the size of the difference to reliably contain pollutants

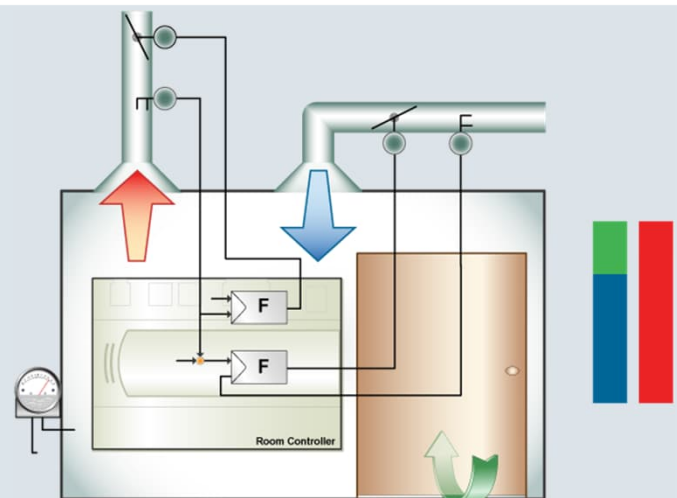

© Copyright 2026
Page 30

30

Cascade control

Measure pressure difference across room boundary

Compare to selected setpoint

Control supply and exhaust flow

Enforce a difference between them

Dynamically adjust flow difference to maintain pressure setpoint

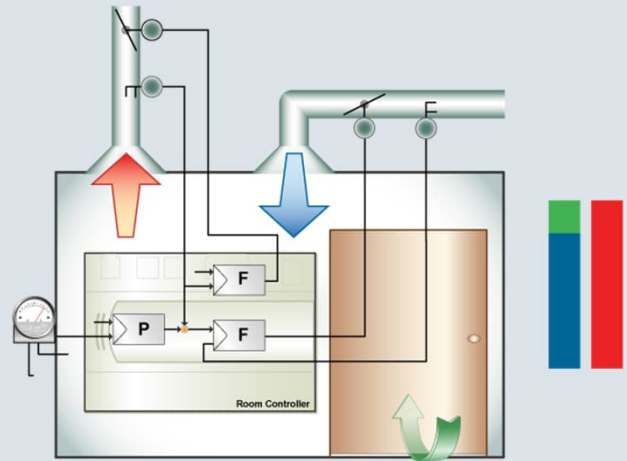

© Copyright 2026
Page 31

31

Selecting a control method

Factors that affect selection

- 1 Tightness of envelope
- 2 Number of pressure levels needed
- 3 Speed of disturbances and response
- 4 Duct conditions for flow measurement

© Copyright 2026
Page 32

Reference: 2010 ASHRAE Handbook, HVAC Applications. Chapter 17 Laboratory Systems, page 16.12

32

Tightness of envelope

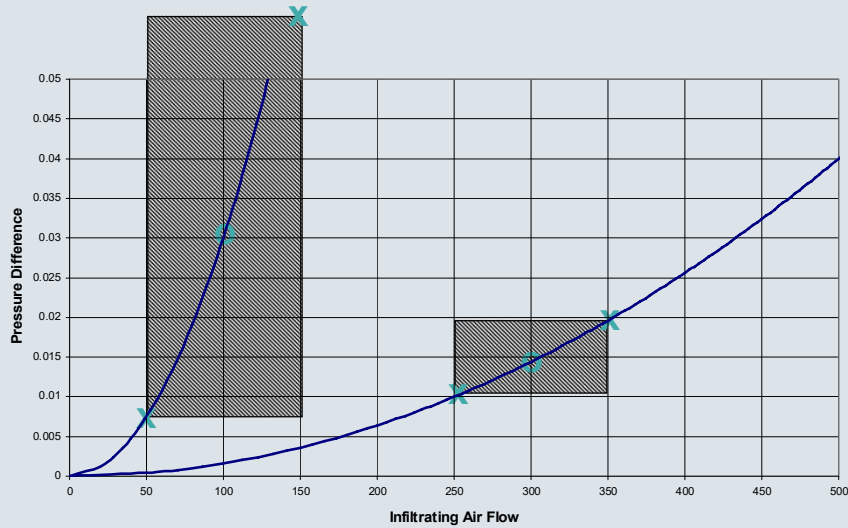

© Copyright 2026
Page 33

33

Number of pressure levels

Relatively simple requirement

2-levels, OK for Differential Flow Tracking

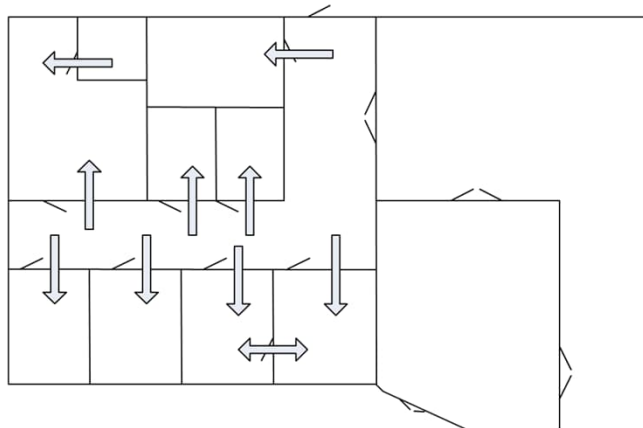

© Copyright 2026
Page 34

34

Number of pressure levels

Indicate intended relative pressure levels

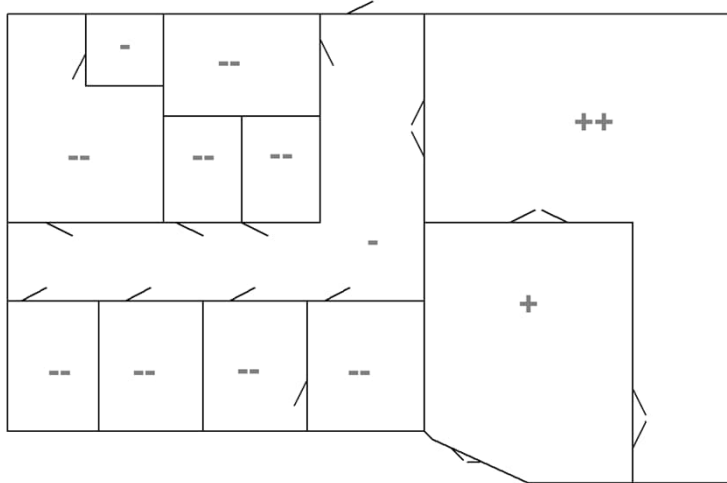

© Copyright 2026
Page 35

35

Design considerations: Effect of air flow accuracy

Numerical illustration

	Nominal value	Error
Exhaust flow	1000	+/- 100
Supply flow	850	+/- 85
Transfer flow	150	+/- 185

Base flow control accuracy on desired infiltration
ANSI Z9.5, Laboratory Ventilation

© Copyright 2026
Page 36

36

Select pressurization level

Based on leakage area

Example: 150 cfm
for $\frac{1}{2}$ square foot

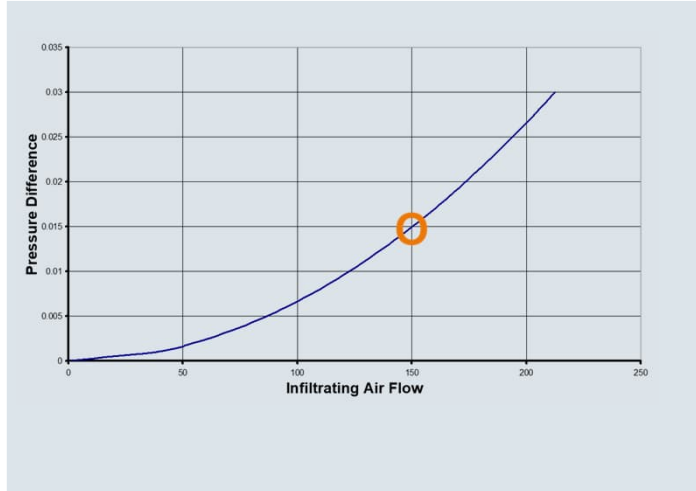

© Copyright 2026
Page 37

37

Select accuracy target

Based on need
to control contaminants

Not product spec's

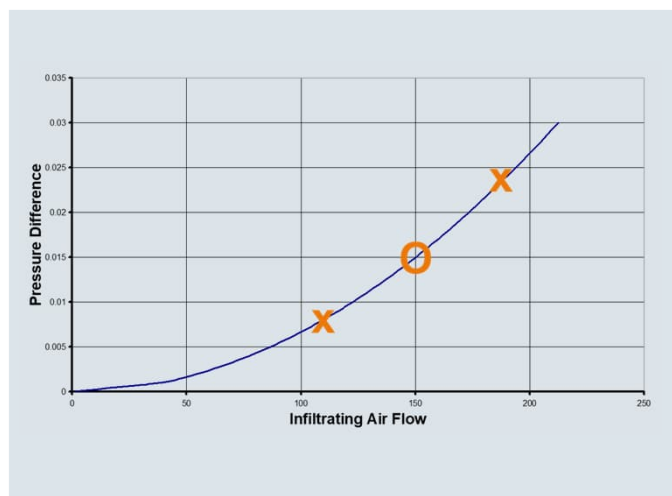

© Copyright 2026
Page 38

38

Derive flow control accuracy

Base flow control accuracy on desired infiltration
Select allowable error on supply and exhaust
for resulting transfer accuracy

	Nominal value	Error
Exhaust flow	1000	+/- 30
Supply flow	850	+/- 30
Transfer flow	150	+/- 45

Combine errors with square root of sum of squares

© Copyright 2026
Page 39

39

Derive Flow Control Accuracy

For VAV:

Consider accuracy across range of flow values

Pressurization specs easier to meet at low flow

	Nominal value	Error
Exhaust flow	1000	+/- 30
	200	+/- 30
Supply flow	850	+/- 30
	50	+/- 30
Transfer flow	150	+/- 45

© Copyright 2026
Page 40

40

Design considerations: Which terminal does pressurization

Exhaust tracks supply

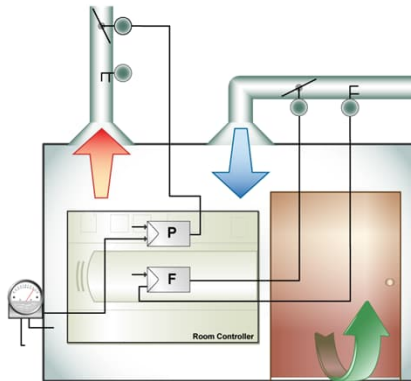

Supply tracks exhaust

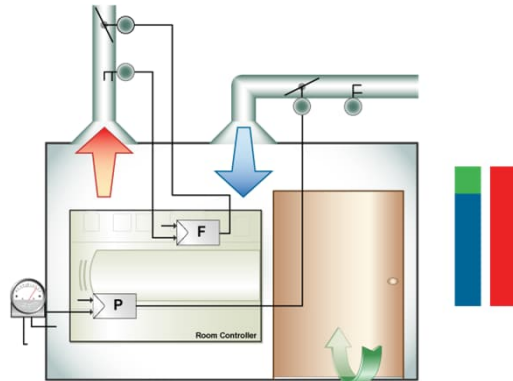

© Copyright 2026
Page 41

41

Design considerations: Room pressure monitor



Design standards call
for installed monitor

Operating standards call
for "periodic check"

Failure mode analysis
justifies monitor as a
device separate from
the controller

© Copyright 2026
Page 42

42

Agenda

- 1 Introduction (concept, purpose, ...)
- 2 Physics: Infiltration and Containment
- 3 Pressurization Methods
- 4 Design Considerations
- 5 Summary and Contamination Control

© Copyright 2020
Page 43

43

Pressurization and contaminant control

Contaminant control can be very important or only slightly important

Biosafety standards recognize range of hazards and range of responses

Engineering and commissioning should match effort and solutions to needs

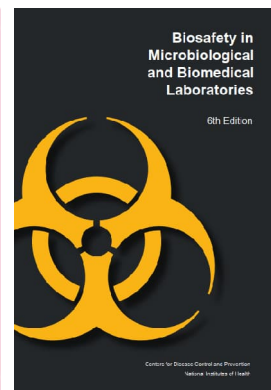
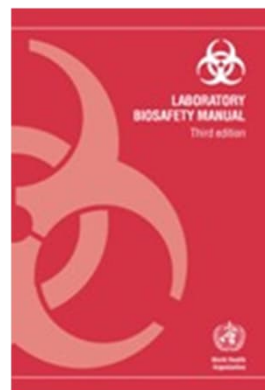

© Copyright 2026
Page 44

44

Levels of contaminant control

Pressurization is one tool

Door is another

- BSL 1 – Laboratories should have doors
- BSL 2 – Doors should be self-closing
- BSL 3 – Series of two self-closing doors
- BSL 4 – Airlock with air tight doors



© Copyright 2026
Page 45

45

Summary

Space pressurization: tool for contamination control,
not a 'magic shield'

Envelope leakage is main mechanical parameter

Several HVAC control methods

- Differential flow control is used most often
- Choice usually driven by envelope

Monitor operation with equipment and procedures

© Copyright 2026
Page 46

46

Assessment questions

1. Name two kinds of spaces where pressurization is important.
(laboratories, healthcare spaces, clean manufacturing)
2. Identify 1 method of pressurization control
(direct pressure feedback, flow offset, or cascade control)
3. Which pressurization method is most effective for when the door is open? (trick question, no method works with an open door)
4. What is the most important physical characteristic of a room for pressurization design? (envelope leakage area)
5. Which is the physical goal, room pressure, differential air flow, containment? (containment)

© Copyright 2026
Page 47

47



Questions?

Answers!

© Copyright 2020
Page 48

48

Contact

Jim Coogan
Principal Application
Engineer

Siemens Smart Infrastructure

E-mail
jim.coogan@
siemens.com

